

SMART VALVE SVM-21

SMART M-BUS VALVE



Features:

- M-Bus operated ON/OFF valve
- Valve size from DN15 to DN40
- Compatible with all M-Bus Masters
- IP68 protection
- Software enabled monitoring and control
- Battery operated with low power consumption
- Suitable for potable and chilled water applications

SMART VALVE SVM-21

SMART M-BUS VALVE

TECHNICAL DATA		
Nominal Diameter	mm	DN15 to DN40
Ambient Temperature	°C	-25 to 65
Operating Temperature	°C	-10 to 110
Pressure Rating	Bar	PN16 / 20
Protection	-	IP67 enclosure IP68 body
Communication	-	Wired M-Bus
Material of Construction (MOC)	-	Brass
Power Supply	-	Battery ; lifetime up-to 12 years
Data Read Option	-	Valve OPEN/CLOSE Command and Errors [Reporting errors : Valve operation error & M-Bus communication error]
Cable Length	-	1m
Data Write Option	-	OPEN/CLOSE Command

DIMENSIONS

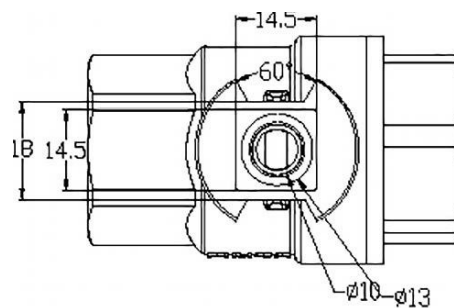
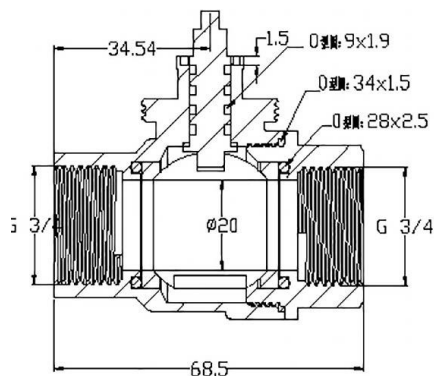
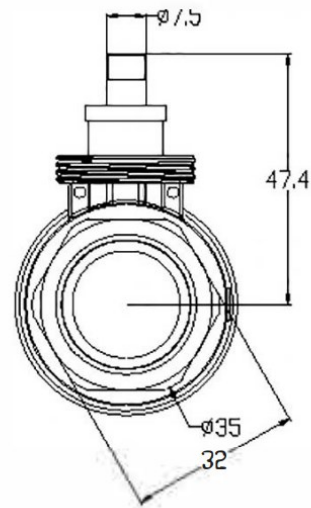
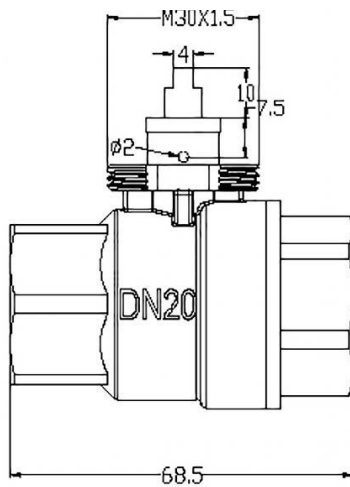

KIMANS Inc.

SMART VALVE SVM-21

SMART M-BUS VALVE

SOFTWARE INTERFACE

